

# Maps of Baldia Town 21 Sectors

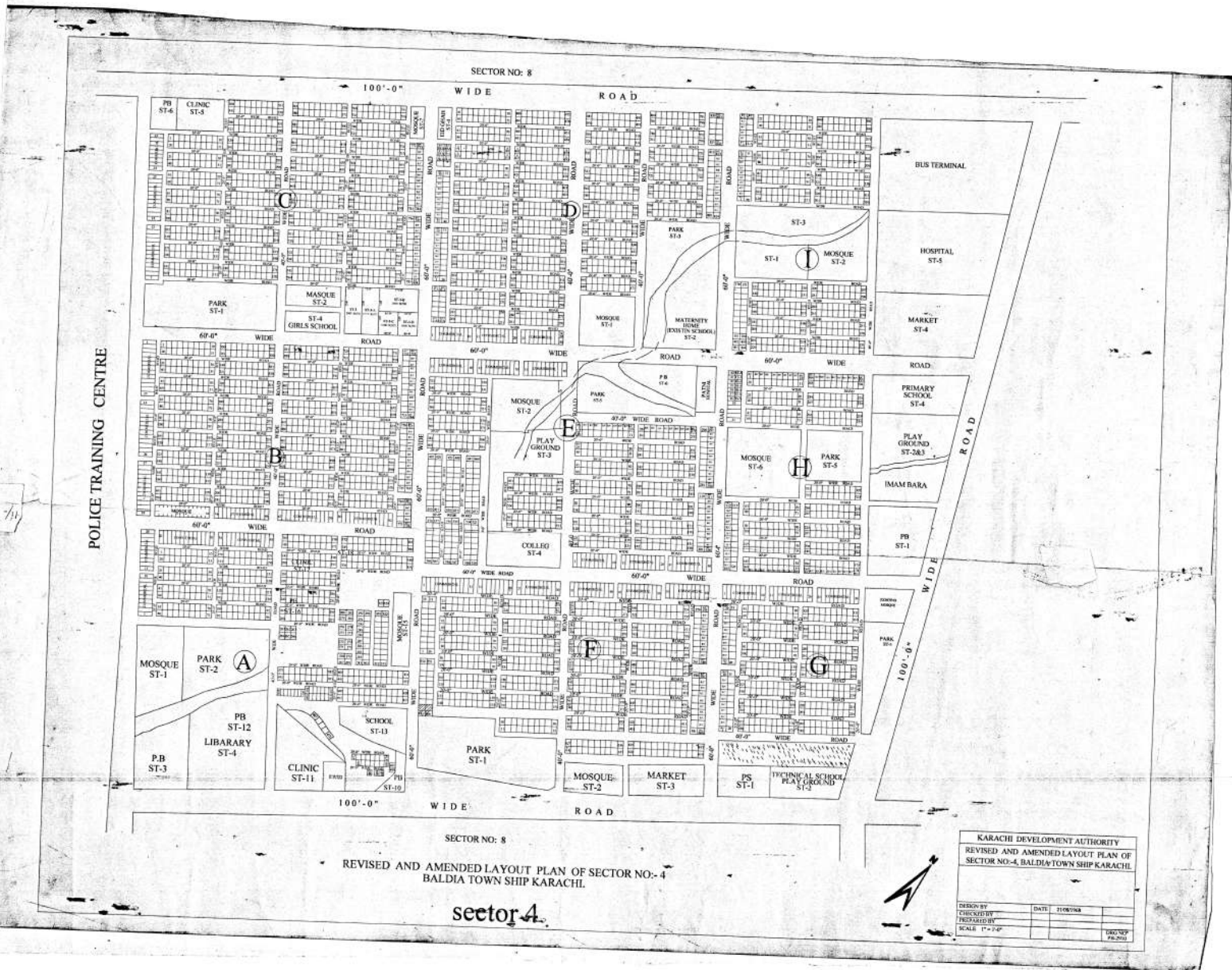

# SECTOR - 8

# SECTOR - 21

# SECTOR - 11

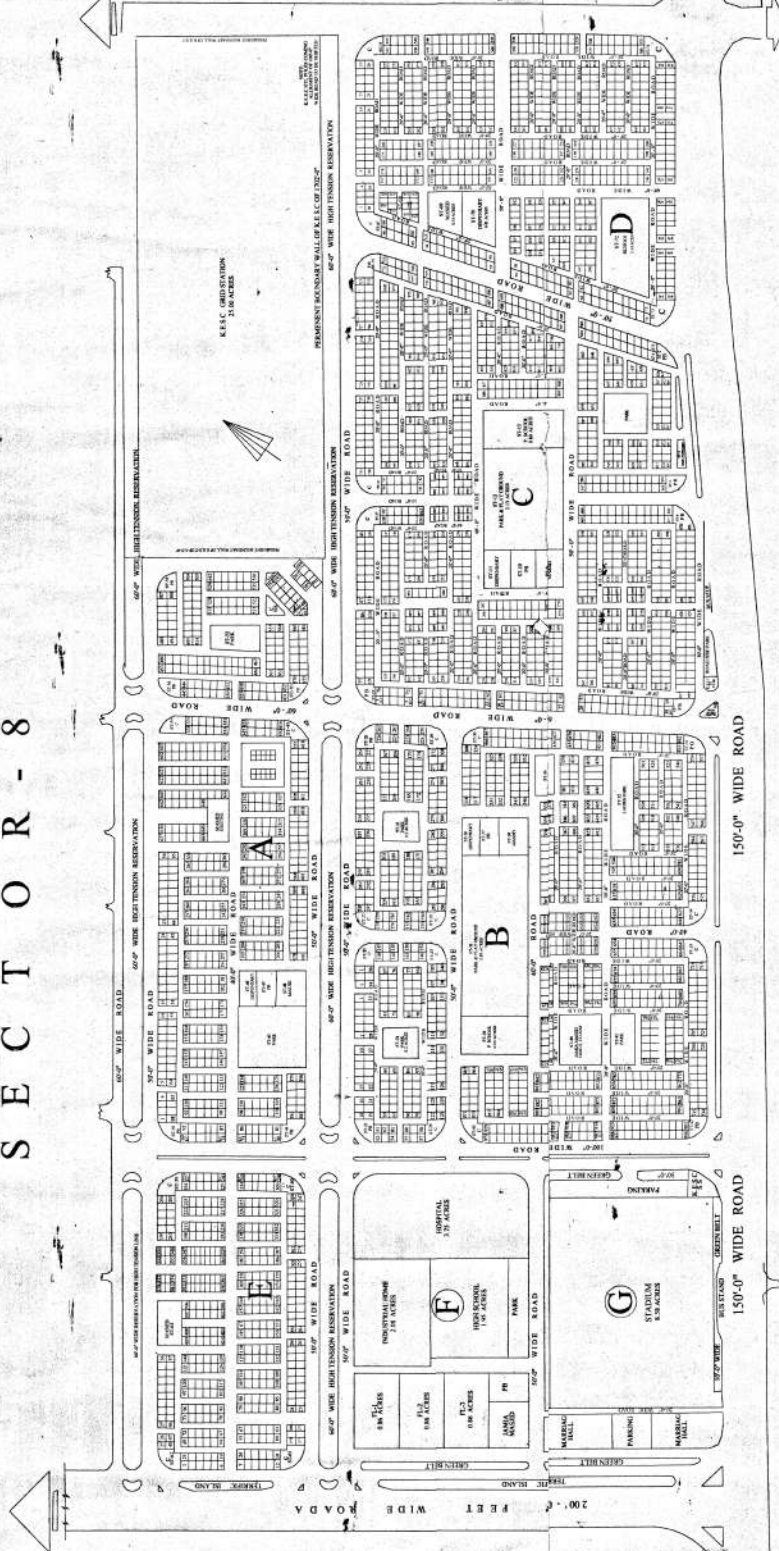

KADACHI METROPOLITAN CORPORATION	
DIRECTORATE OF URBAN AREAS EVALUATION	
TOWN PLANNING	
SECTOR NO.8, BALDA TOWNSHIP	
SCALE TO	
SCALE FROM	
SCALE 1:1000	1:1000

# SECTOR - 4

200'-0" WIDE ROAD

200'-0" WIDE ROAD

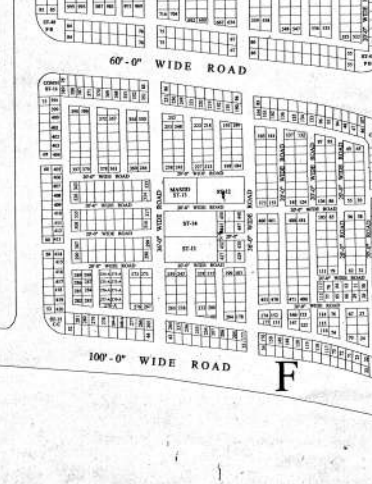
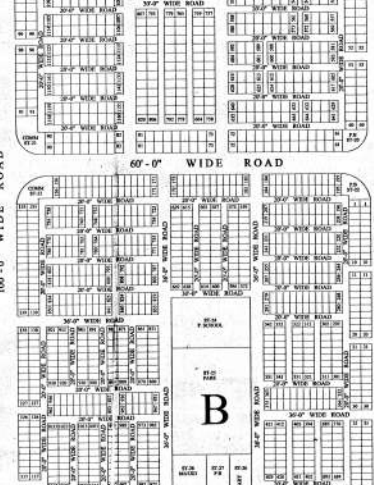
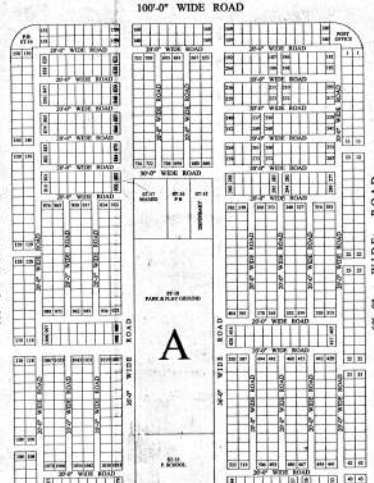
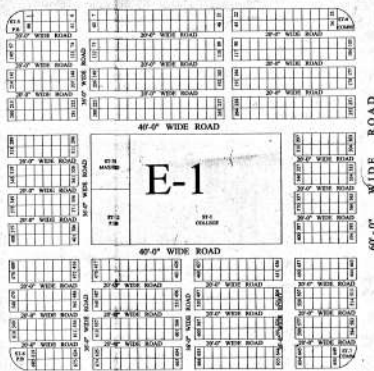

KARACHI METROPOLITAN CORPORATION			
DIRECTORATE OF KUTCH ABADIS EVALUATION			
NO.	DATE	PLANNING	SECTION
PREPARED BY	DATE	REVISION	SECTION
APPROVED BY	DATE	REVISION	SECTION

KARACHI METROPOLITAN CORPORATION  
 DIRECTORATE OF KUTCH ABADIS EVALUATION  
 TOWN PLANNING  
 AS PER CR NO. \_\_\_\_\_  
 DATE OF CR \_\_\_\_\_

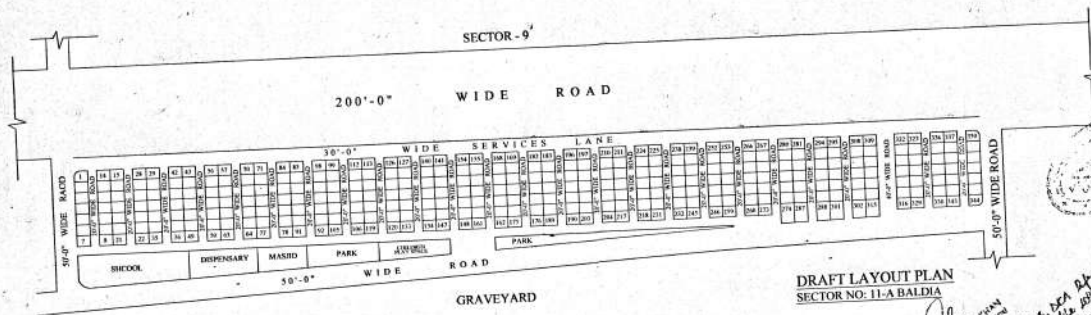

DRAFT LAYOUT PLAN  
SECTOR NO: 11-A BALDIA

*Handwritten notes:*  
 Approved by the  
 Director of Public Health  
 and Sanitation  
 Karachi  
 on 15/11/13  
 11-5-93

KARACHI METROPOLITAN CORPORATION			
LAYOUT PLAN OF SECTOR NO: 11-A, BALDIA TOWN SHIP KARACHI.			
DESIGN BY	DATE		
CHECKED BY			
PREPARED BY			DRG NO.
SCALE 1" = 100'-0"			

11-B



LAYOUT OF SECTOR 11B

Notes:  
1. The lots shown on this plan are subject to the provisions of the City Ordinance No. 11 of 1954.  
2. The lots shown on this plan are subject to the provisions of the City Ordinance No. 11 of 1954.  
3. The lots shown on this plan are subject to the provisions of the City Ordinance No. 11 of 1954.

**CITY DISTRICT GOVERNMENT KARACHI**  
**LAYOUT PLAN OF SECTOR NO 11.C**  
**BALDIA TOWN SHIP KARACHI**

SCHEME 'A'

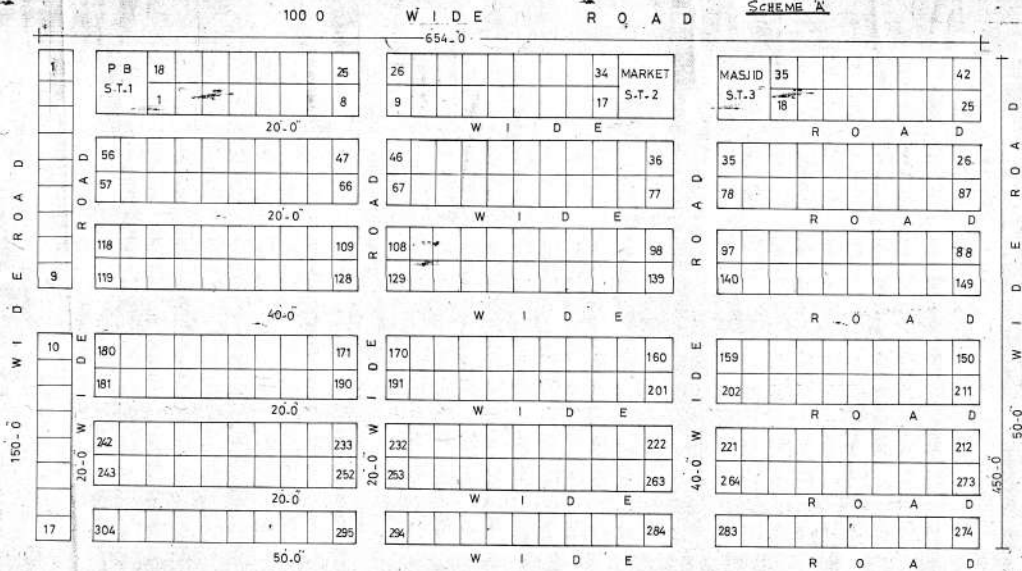

SCHEDULE OF PLOTS			
SNO	LAND USE	SIZE	NO
1	RESIDENTIAL	24-0X30-0	304
2	COMMERCIAL	24-0X30-0	42
3	P. BUILDING S.T.1	48-0X60-0	01
4	MARKET S.T.2	48-0X60-0	01
5	MASJID S.T.3	48-0X60-0	01
TOTAL NOS OF PLOTS			349



**PLAN**  
SCALE 1=400

PREPARED BY	LAND SURVEYOR	ASST. DIST. OFFR. LAND REV.	DIST. OFFICER LAND REV. C.O.G.K.

# sector 12

12-A

12-C-II

12-C

12-C-I

14-EXT

SEC 13

128'-0" WIDE ROAD

128'-0" WIDE ROAD

128'-0" WIDE ROAD

128'-0" WIDE ROAD

128'-0" WIDE ROAD

128'-0" WIDE ROAD

128'-0" WIDE ROAD

128'-0" WIDE ROAD

128'-0" WIDE ROAD

128'-0" WIDE ROAD

128'-0" WIDE ROAD

128'-0" WIDE ROAD

128'-0" WIDE ROAD

128'-0" WIDE ROAD

128'-0" WIDE ROAD

128'-0" WIDE ROAD

128'-0" WIDE ROAD

128'-0" WIDE ROAD

128'-0" WIDE ROAD

128'-0" WIDE ROAD

128'-0" WIDE ROAD

128'-0" WIDE ROAD

128'-0" WIDE ROAD

128'-0" WIDE ROAD

128'-0" WIDE ROAD

128'-0" WIDE ROAD

128'-0" WIDE ROAD

128'-0" WIDE ROAD

128'-0" WIDE ROAD

128'-0" WIDE ROAD

128'-0" WIDE ROAD

128'-0" WIDE ROAD

128'-0" WIDE ROAD

128'-0" WIDE ROAD

128'-0" WIDE ROAD

128'-0" WIDE ROAD

128'-0" WIDE ROAD

128'-0" WIDE ROAD

128'-0" WIDE ROAD

128'-0" WIDE ROAD

128'-0" WIDE ROAD

128'-0" WIDE ROAD

**NOTES**  
1. All dimensions shown on this plan are to be taken from the centerline of the road unless otherwise specified.  
2. All lots shown on this plan are to be of equal area unless otherwise specified.  
3. All lots shown on this plan are to be of equal width unless otherwise specified.  
4. All lots shown on this plan are to be of equal length unless otherwise specified.  
5. All lots shown on this plan are to be of equal area unless otherwise specified.

This plan was prepared by the  
Karachi Metropolitan Corporation  
Karachi Special Development Project  
Katchi Abadi (Phase II)  
Sector 12  
Balda Township

KARACHI METROPOLITAN CORPORATION  
KARACHI SPECIAL DEVELOPMENT PROJECT  
KATCHI ABADI (PHASE II)  
BALDA TOWNSHIP  
SECTOR 12

DATE: 1978  
SCALE: 1:1000

DESIGNED BY: [Name]  
DRAWN BY: [Name]

CHECKED BY: [Name]

APPROVED BY: [Name]

DATE: 1978

SCALE: 1:1000

DESIGNED BY: [Name]

DRAWN BY: [Name]

CHECKED BY: [Name]

APPROVED BY: [Name]

DATE: 1978

SCALE: 1:1000

DESIGNED BY: [Name]

DRAWN BY: [Name]

CHECKED BY: [Name]

APPROVED BY: [Name]

DATE: 1978

SCALE: 1:1000

SECTOR NO: 17-A

SECTOR NO: 14-A

SECTOR NO: 14-B,

200'-0" WIDE ROAD

KARACHI METROPOLITAN CORPORATION  
DIRECTORATE OF EARTH AND ENVIRONMENTAL  
ENGINEERING  
LAYOUT PLAN OF SECTOR NO: 14-A, 14-B  
& 17-A, BALDIA TOWNSHIP KARACHI.  
AS PER CR. NO.  
DATE OF CR.  
SCALE: 1/8" = 1'-0"



SECTOR NO: 14-C

SECTOR NO: 14

125' - 0" W I D E R O A D



SECTOR NO: 12



KARACHI METROPOLITAN CORPORATION

LAYOUT PLAN OF SECTOR NO: 14-C  
BALDA TOWNSHIP KARACHI

SCALE 1/8" = 10'

HUB RIVER ROAD



750-0 WIDE ROAD

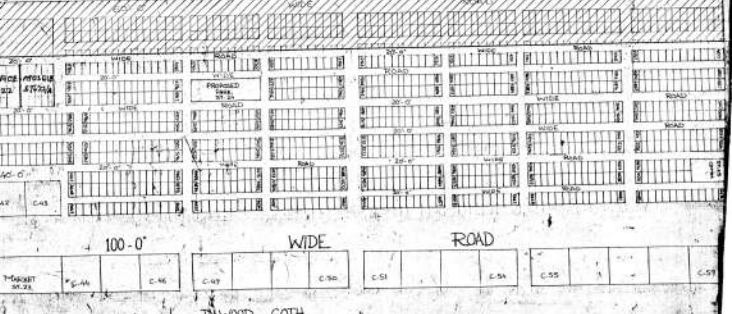
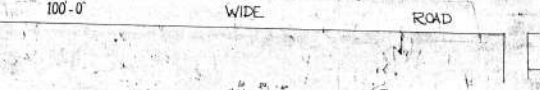
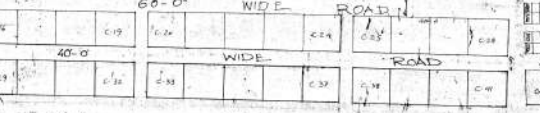
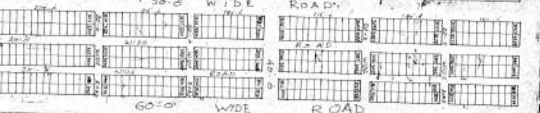
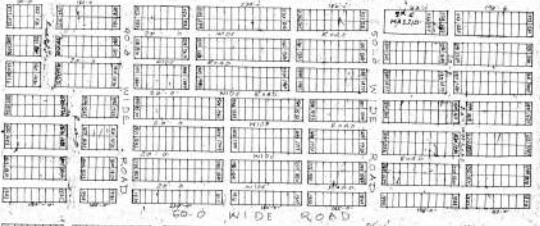

PAKISTAN NAVAL COLONY

DAWOOD GOTH



**SCHEDULE OF PLOTS**

SNO	DESCRIPTION	SIZE	AREA	TYPE
1	Residential	1/2 Acre	20,000	100
2	Commercial	1/2 Acre	20,000	100
3	Industrial	1/2 Acre	20,000	100
4	Government	1/2 Acre	20,000	100

1. Land has been offered to K.N.C. Council, 144, Commercial Buildings, 201, 202, 203, 204, 205, 206, 207, 208, 209, 210, 211, 212, 213, 214, 215, 216, 217, 218, 219, 220, 221, 222, 223, 224, 225, 226, 227, 228, 229, 230, 231, 232, 233, 234, 235, 236, 237, 238, 239, 240, 241, 242, 243, 244, 245, 246, 247, 248, 249, 250, 251, 252, 253, 254, 255, 256, 257, 258, 259, 260, 261, 262, 263, 264, 265, 266, 267, 268, 269, 270, 271, 272, 273, 274, 275, 276, 277, 278, 279, 280, 281, 282, 283, 284, 285, 286, 287, 288, 289, 290, 291, 292, 293, 294, 295, 296, 297, 298, 299, 300, 301, 302, 303, 304, 305, 306, 307, 308, 309, 310, 311, 312, 313, 314, 315, 316, 317, 318, 319, 320, 321, 322, 323, 324, 325, 326, 327, 328, 329, 330, 331, 332, 333, 334, 335, 336, 337, 338, 339, 340, 341, 342, 343, 344, 345, 346, 347, 348, 349, 350, 351, 352, 353, 354, 355, 356, 357, 358, 359, 360, 361, 362, 363, 364, 365, 366, 367, 368, 369, 370, 371, 372, 373, 374, 375, 376, 377, 378, 379, 380, 381, 382, 383, 384, 385, 386, 387, 388, 389, 390, 391, 392, 393, 394, 395, 396, 397, 398, 399, 400, 401, 402, 403, 404, 405, 406, 407, 408, 409, 410, 411, 412, 413, 414, 415, 416, 417, 418, 419, 420, 421, 422, 423, 424, 425, 426, 427, 428, 429, 430, 431, 432, 433, 434, 435, 436, 437, 438, 439, 440, 441, 442, 443, 444, 445, 446, 447, 448, 449, 450, 451, 452, 453, 454, 455, 456, 457, 458, 459, 460, 461, 462, 463, 464, 465, 466, 467, 468, 469, 470, 471, 472, 473, 474, 475, 476, 477, 478, 479, 480, 481, 482, 483, 484, 485, 486, 487, 488, 489, 490, 491, 492, 493, 494, 495, 496, 497, 498, 499, 500, 501, 502, 503, 504, 505, 506, 507, 508, 509, 510, 511, 512, 513, 514, 515, 516, 517, 518, 519, 520, 521, 522, 523, 524, 525, 526, 527, 528, 529, 530, 531, 532, 533, 534, 535, 536, 537, 538, 539, 540, 541, 542, 543, 544, 545, 546, 547, 548, 549, 550, 551, 552, 553, 554, 555, 556, 557, 558, 559, 560, 561, 562, 563, 564, 565, 566, 567, 568, 569, 570, 571, 572, 573, 574, 575, 576, 577, 578, 579, 580, 581, 582, 583, 584, 585, 586, 587, 588, 589, 590, 591, 592, 593, 594, 595, 596, 597, 598, 599, 600, 601, 602, 603, 604, 605, 606, 607, 608, 609, 610, 611, 612, 613, 614, 615, 616, 617, 618, 619, 620, 621, 622, 623, 624, 625, 626, 627, 628, 629, 630, 631, 632, 633, 634, 635, 636, 637, 638, 639, 640, 641, 642, 643, 644, 645, 646, 647, 648, 649, 650, 651, 652, 653, 654, 655, 656, 657, 658, 659, 660, 661, 662, 663, 664, 665, 666, 667, 668, 669, 670, 671, 672, 673, 674, 675, 676, 677, 678, 679, 680, 681, 682, 683, 684, 685, 686, 687, 688, 689, 690, 691, 692, 693, 694, 695, 696, 697, 698, 699, 700, 701, 702, 703, 704, 705, 706, 707, 708, 709, 710, 711, 712, 713, 714, 715, 716, 717, 718, 719, 720, 721, 722, 723, 724, 725, 726, 727, 728, 729, 730, 731, 732, 733, 734, 735, 736, 737, 738, 739, 740, 741, 742, 743, 744, 745, 746, 747, 748, 749, 750, 751, 752, 753, 754, 755, 756, 757, 758, 759, 760, 761, 762, 763, 764, 765, 766, 767, 768, 769, 770, 771, 772, 773, 774, 775, 776, 777, 778, 779, 780, 781, 782, 783, 784, 785, 786, 787, 788, 789, 790, 791, 792, 793, 794, 795, 796, 797, 798, 799, 800, 801, 802, 803, 804, 805, 806, 807, 808, 809, 810, 811, 812, 813, 814, 815, 816, 817, 818, 819, 820, 821, 822, 823, 824, 825, 826, 827, 828, 829, 830, 831, 832, 833, 834, 835, 836, 837, 838, 839, 840, 841, 842, 843, 844, 845, 846, 847, 848, 849, 850, 851, 852, 853, 854, 855, 856, 857, 858, 859, 860, 861, 862, 863, 864, 865, 866, 867, 868, 869, 870, 871, 872, 873, 874, 875, 876, 877, 878, 879, 880, 881, 882, 883, 884, 885, 886, 887, 888, 889, 890, 891, 892, 893, 894, 895, 896, 897, 898, 899, 900, 901, 902, 903, 904, 905, 906, 907, 908, 909, 910, 911, 912, 913, 914, 915, 916, 917, 918, 919, 920, 921, 922, 923, 924, 925, 926, 927, 928, 929, 930, 931, 932, 933, 934, 935, 936, 937, 938, 939, 940, 941, 942, 943, 944, 945, 946, 947, 948, 949, 950, 951, 952, 953, 954, 955, 956, 957, 958, 959, 960, 961, 962, 963, 964, 965, 966, 967, 968, 969, 970, 971, 972, 973, 974, 975, 976, 977, 978, 979, 980, 981, 982, 983, 984, 985, 986, 987, 988, 989, 990, 991, 992, 993, 994, 995, 996, 997, 998, 999, 1000.

PAKISTAN NAVAL COLONY

LAYOUT OF  
**SECTOR NO. 19-A**

**SECTOR NO. 21**

**SECTOR NO. 17-B**

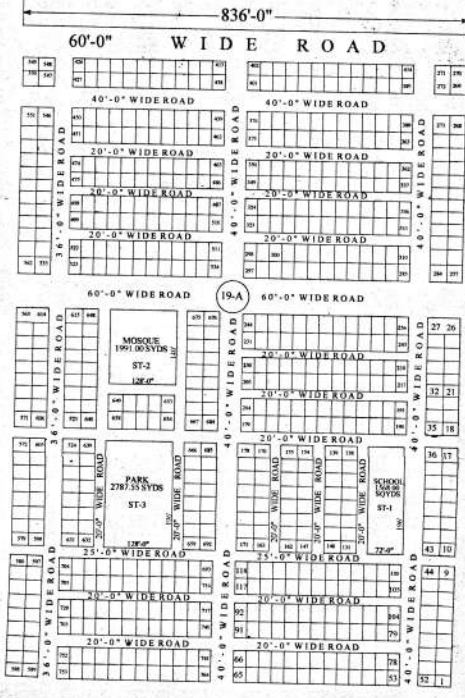

200'-0" WIDE ROAD

**SECTOR NO. 20**

**NOTE**

1. All dimensions shown are in feet - except where otherwise stated.
2. All proposed roads/plots are to be built under clearance.
3. All details of proposed concrete and drainage payments see S.O. No. 145-10-01, 00/12.
4. All proposed plots belong to the Government - 50% & 50% road are respectively CIVIL - COMMERCIAL PLOTS.

LAND USE	SECTOR	SIZE	NO. OF PLOTS	AREA IN SQ. YDS.	PERCENTAGE
RESIDENTIAL	19	6420	657	613200	38.40%
COMMERCIAL	19	2500	107	267500	16.00%
PARK	19	2787.33	1	2787.33	0.17%
SCHOOL	19	807	1	807	0.05%
MOBILE	19	1991	1	1991	0.12%
ROAD	19	1500	1	1500	0.09%
TOTAL	19	11000	968	1100000	100%

KARACHI METROPOLITAN CORPORATION  
OFFICE OF THE S.D. DIRECTOR LAND & ESTATE, K.M.C.  
PROPOSED LAY OUT PLAN DEVELOPMENT (BALDA) - SECTOR 19/A